

# NORWEGIAN EPIC DECK PLANS

## FEATURES

- 24 Dining Options/ 20 Bars & Lounges
- Aqua Park/Main Pool®
- 3 Waterslides, including the Epic Plunge
- 1 Kids' Pool
- 6 Hot Tubs
- The Haven by Norwegian®
- Spa Suites & Spa Balcony Staterooms
- Studios & Studio Lounge
- Family Accommodations
- Two 3-Lane Bowling Alleys
- Climbing Walls & Rappelling Wall
- Casino
- Adult-Only Clubs
- Spa & Beauty Salon
- Fitness Center
- Youth Centers

◇ Heated pool available

## SYMBOL LEGEND

- Stateroom with facilities for the disabled (For information, contact Reservations)
- PrivaSea partially enclosed balcony
- ↕ Connecting staterooms
- ▲ Third-person occupancy available
- + Third- and/or fourth-person occupancy available
- ★ Third-, fourth- and/or fifth-person occupancy available
- ☆ Up-to-sixth-person occupancy available
- ⊠ Elevator
- RR Restroom

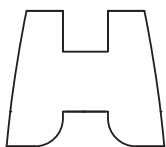
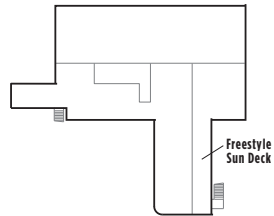
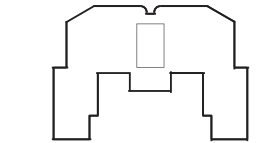
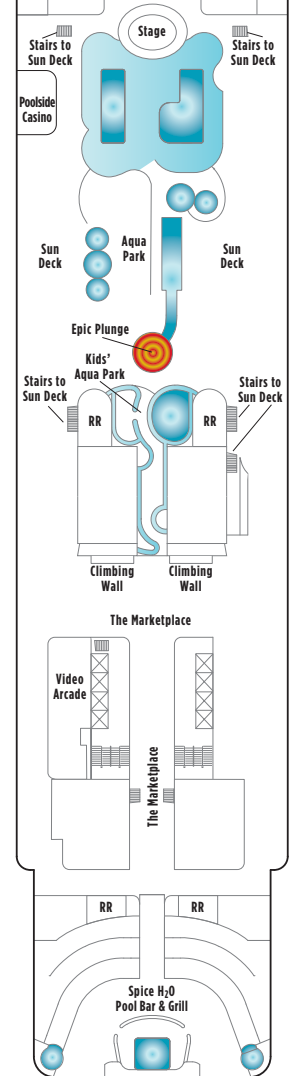
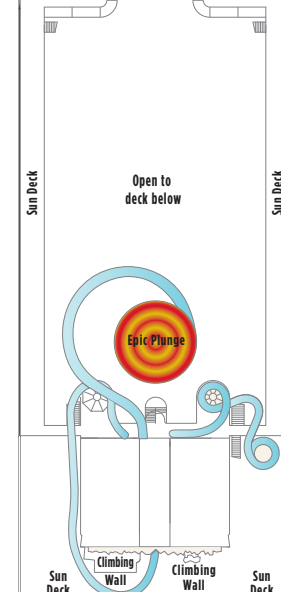
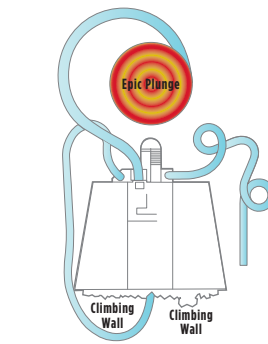
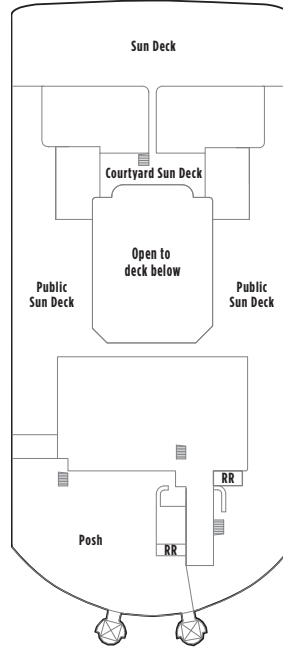
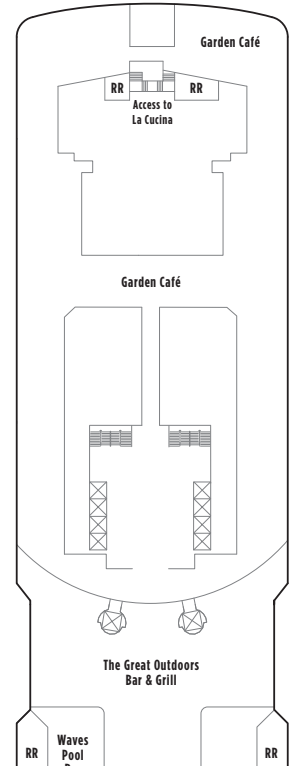
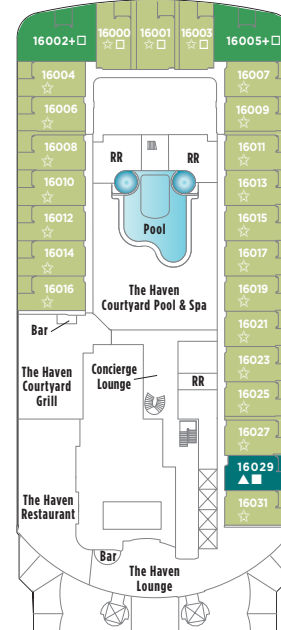
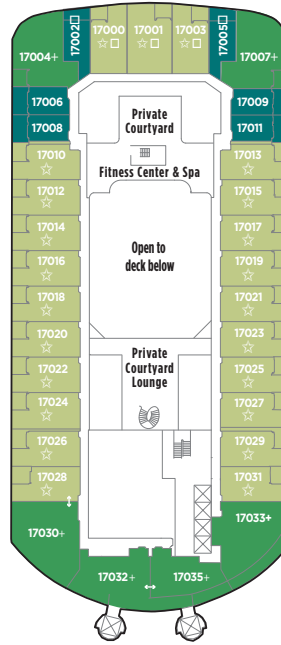

DECK 19

DECK 18

DECK 17

DECK 16

DECK 15

H2 H4 H5

H2 H4 H5

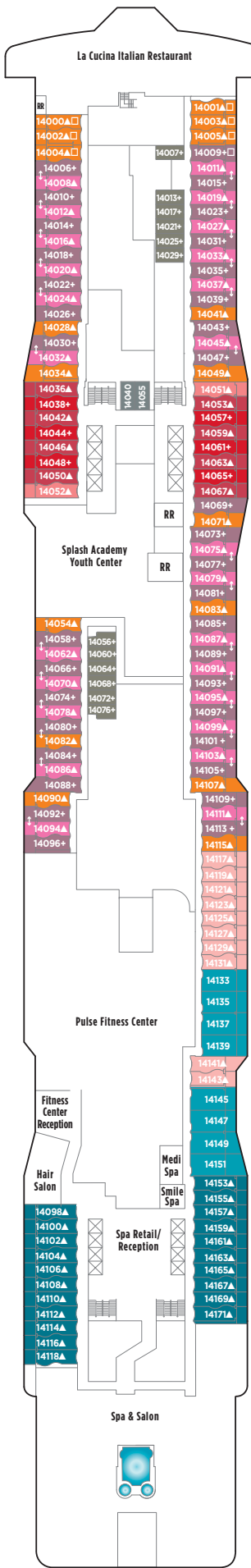

H9 M9 M2 M3 MC B9 I1 IA  
B2 B3 B4

DECK 14

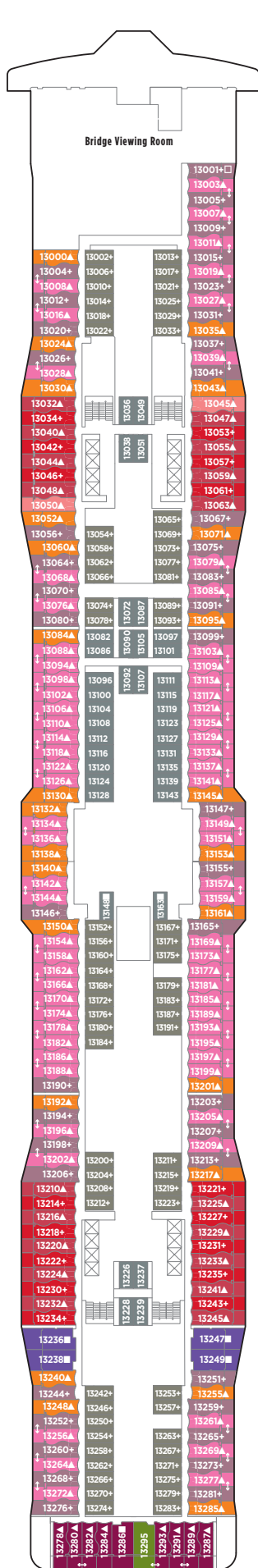

H6 M2 M3 MC B1 B2 B3 B4  
BD I1 IA

DECK 13

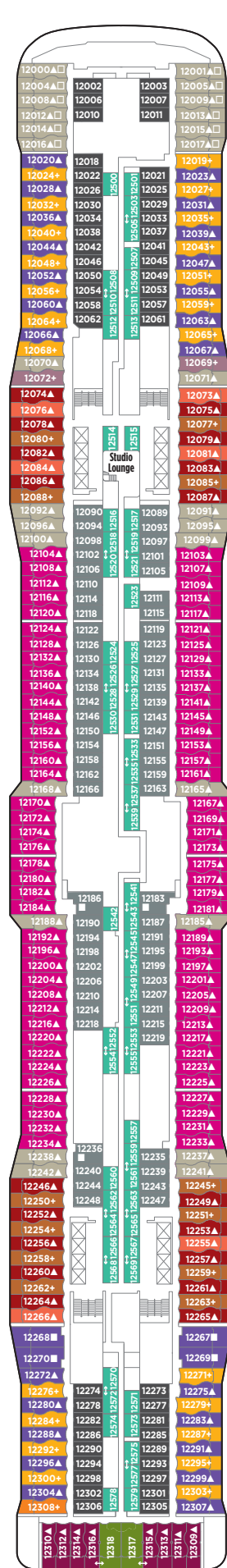

H6 M4 MA MB B1 B5 B6 BA  
BD IA IB ID T1

DECK 12

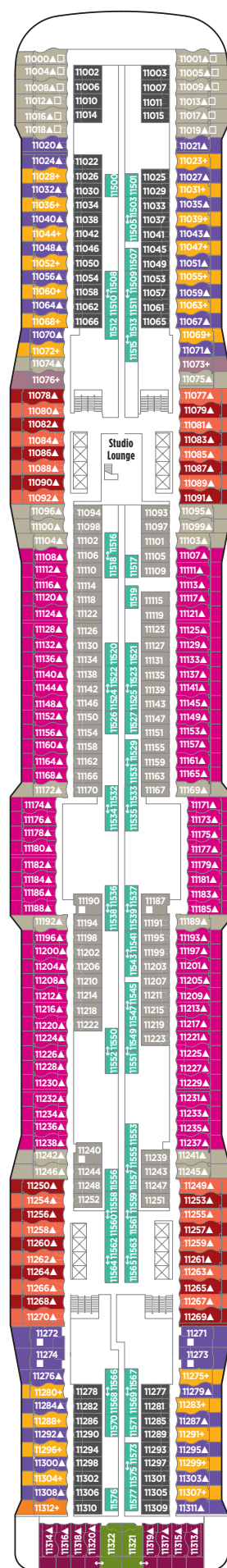

H6 MA MB B1 B5 B6 BA BD  
IB ID T1

DECK 11

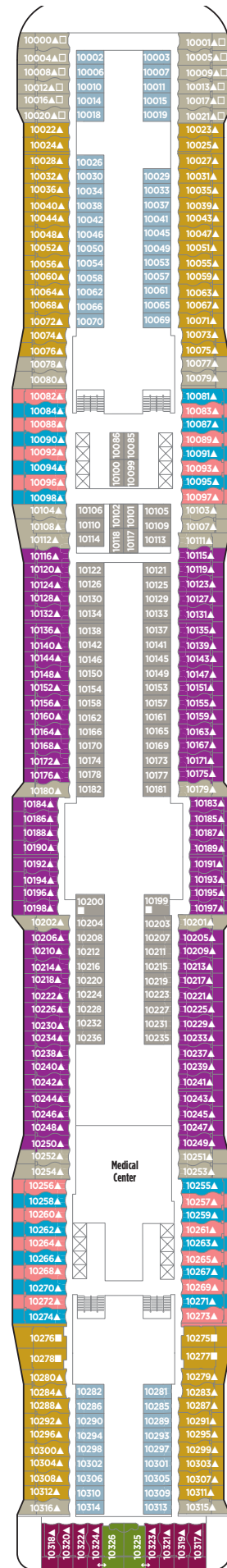

H6 MC MD B1 B6 BB BE IB  
IE

DECK 10



# NORWEGIAN EPIC ACCOMMODATIONS

## THE HAVEN BY NORWEGIAN

Located at the top of the ship, The Haven features a 24-hour butler, concierge service, a private courtyard, private restaurant and bar. All Suites offer luxury baths and private balconies.

### H2 THE HAVEN DELUXE OWNER'S SUITE WITH LARGE BALCONY

These Suites, located in The Haven, offer amazing ocean views through floor-to-ceiling windows and an extra-spacious balcony. They include a king-size bed and additional bedding that accommodates two. Some also feature an enclosed balcony with a sliding glass window, which is indicated on the deck plan. Sleeps up to four.

### H4 THE HAVEN 2-BEDROOM FAMILY VILLA WITH BALCONY

Located in The Haven, these Suites are perfect for the family. They include two bedrooms, two bathrooms and incredible views. Some also feature an enclosed balcony with a sliding glass window, which is indicated on the deck plan. Sleeps up to six.

### H5 THE HAVEN COURTYARD PENTHOUSE WITH BALCONY

These Penthouses, located in The Haven, include a queen-size circular bed and luxury private balcony with a fantastic view. Some feature an enclosed balcony with a sliding glass window, which is indicated on the deck plan. Sleeps up to three.

### H6 THE HAVEN AFT-FACING PENTHOUSE WITH BALCONY

These Penthouses feature a queen-size circular bed, and because they are aft-facing, they offer an unforgettable view from the private balcony. Sleeps up to two.

### H9 THE HAVEN SPA SUITE WITH BALCONY

These Suites are the perfect way to experience a total spa vacation. They include a queen-size circular bed, hot tub, spa décor, easy access to the adjacent Mandara Spa and fitness center, as well as complimentary access to the Thermal Spa Suites during regular spa hours. Sleeps up to two.

## MINI-SUITE AND BALCONY STATEROOMS

Mini-Suites offer a little more space than Balcony Staterooms. All staterooms feature two lower beds that convert to queen-size and curved walls with a unique bathroom treatment where every space is separate.

### M9 SPA MINI-SUITE WITH BALCONY

The Spa Mini-Suites feature soothing spa décor and include easy access to the Mandara Spa and fitness center and complimentary access to the Thermal Spa Suites during regular spa hours. Sleeps up to three.

### M2 M3 M4 FAMILY MINI-SUITE WITH BALCONY\*

These Mini-Suites are perfect if you want to bring the kids. They include a pullman bed and a sofa bed. Hang out with the gang and enjoy the view from your own private balcony. Deck level and location determine the category. Sleeps up to four. Category M3 sleeps three.

### MA MB MC MD MX MID-SHIP MINI-SUITE WITH BALCONY\*

These Mini-Suites feature curved walls and a luxury bath with shower (MB, MD and MX) or tub (MA and MC) and a private balcony with an amazing view. Deck level and location determine the category. Sleeps up to three.

### B9 SPA BALCONY

These staterooms include entry to the Mandara Spa and fitness center and complimentary access to the Thermal Spa Suites during regular spa hours. Sleeps up to three.

### B1 AFT-FACING BALCONY

These staterooms are aft-facing, so the view from your private balcony is amazing. Sleeps up to three.

### B2 B3 B4 FAMILY BALCONY\*

These staterooms are perfect for the whole family. They are conveniently located near the kids' area and some offer a pullman bed and a sofa bed, while others have two lower beds and a sofa bed. There are also many connecting staterooms. Category B2 sleeps up to four. Categories B3 and B4 sleep up to three.

### B5 FAMILY BALCONY

These staterooms are great if you want to bring the kids. They feature additional bedding to accommodate two. Sleeps up to four.

### B6 LARGE BALCONY

These staterooms include additional bedding to accommodate two. A large private balcony offers incredible ocean views. Sleeps up to three.

### BA BB BC MID-SHIP BALCONY\*

These staterooms are mid-ship, so you'll have easy access to all the delicious dining and exciting activities on board. Deck level and location determine the category. Sleeps up to three.

### BD BE BF BX BALCONY\*

These staterooms offer amazing views, and additional bedding can accommodate one guest. Deck level and location determine the category. Sleeps up to three.

## INSIDE AND STUDIO STATEROOMS

These staterooms are the most affordable way to cruise. All Insides feature two lower beds that convert to a queen-size bed. Studios feature a full-size bed.

### I1 FAMILY INSIDE

These staterooms are an affordable family option and are conveniently located near our kids' area. Sleeps up to four.

### IA IB MID-SHIP INSIDE\*

These staterooms are mid-ship, so you'll have easy access to everything on board. Deck level and location determine the category. Sleeps up to two.

### IC ID IE IF IX INSIDE\*

Deck level and location determine the category. Sleeps up to two.

### T1 STUDIO

Private keycard-access complex comprised of staterooms specifically designed and priced for the solo traveler. Featuring a full-size bed, a one-way window to the corridor and separate areas for your bathroom, sink and shower, in 100 square feet of living space. Includes access to the private Studio Lounge. No single supplement required.

## THE HAVEN BY NORWEGIAN®



**H2** THE HAVEN DELUXE OWNER'S SUITE WITH LARGE BALCONY

## MINI-SUITE AND BALCONY STATEROOMS



**M9** SPA MINI-SUITE WITH BALCONY

## INSIDE AND STUDIO STATEROOMS

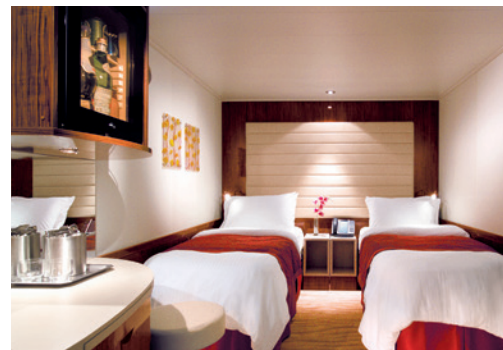

**ID** INSIDE



**H4** THE HAVEN 2-BEDROOM FAMILY VILLA WITH BALCONY



**MA** MID-SHIP MINI-SUITE WITH BALCONY



**T1** STUDIO



**H9** THE HAVEN SPA SUITE WITH BALCONY



**B9** SPA BALCONY



**H6** THE HAVEN AFT-FACING PENTHOUSE WITH BALCONY



**BD** BALCONY

# NORWEGIAN EPIC SCHEMATICS

**H2 THE HAVEN DELUXE OWNER'S SUITE WITH LARGE BALCONY**

Sleeps up to four.



**H4 THE HAVEN 2-BEDROOM FAMILY VILLA WITH BALCONY**

Sleeps up to six.



**MA MID-SHIP MINI-SUITE WITH BALCONY**

Sleeps up to three.



**H5 THE HAVEN COURTYARD PENTHOUSE WITH BALCONY**

Sleeps up to three.



**BD BALCONY**

Sleeps up to three.



**H9 THE HAVEN SPA SUITE WITH BALCONY**

Sleeps up to two.



**ID INSIDE**

Sleeps up to two.



**T1 STUDIO**

Sleeps one.

